



# Kansas City 2019

June 10-15 | #SANSKansasCity

# WELCOME

## GENERAL INFORMATION

### Venue

Kansas City Marriott Country Club Plaza  
4445 Main Street | Kansas City, MO 64111  
816-531-3000

### Event Check-In

**Location: Hyde Park Foyer** (2ND LEVEL)  
Mon, June 10 . . . . . 7:00am – 9:00am

### Registration Support

**Location: Hyde Park** (2ND LEVEL)  
Mon, June 10 – Sat, June 15 . . . . . 9:00am – 5:00pm

### Internet Café

**Location: Grand Ballroom Foyer** (2ND LEVEL)  
Mon, June 10 – Fri, June 14 . . . . . Open 24 hours  
Sat, June 15 . . . . . Closes at 2:00pm

### Course Breaks

Morning Coffee . . . . . 7:00am – 9:00am  
Morning Break . . . . . 10:30am – 10:50am  
Lunch (on your own) . . . . . 12:15pm – 1:30pm  
Afternoon Break . . . . . 3:00pm – 3:20pm

## CLASS INFORMATION

*All courses will run 9:00am – 5:00pm (unless noted)*

### SEC301 Introduction to Cyber Security

Instructor: Kevin Ripa . . . . . Roanoke (2ND LEVEL)

### SEC401 Security Essentials Bootcamp Style

Instructor: Ross Bergman . . . . . Rockhill (2ND LEVEL)  
*Bootcamp Hours: 5:00pm – 7:00pm (Course days 1-5)*

### SEC504 Hacker Tools, Techniques, Exploits, and Incident Handling

Instructor: Ronald Hamann . . . . . Union Hill (2ND LEVEL)  
*Extended Hours: 5:00pm – 7:15pm (Course day 1)*

### SEC530 Defensible Security Architecture and Engineering

Instructor: Greg Scheidel . . . . . Southmoreland (1ST LEVEL)

### SEC560 Network Penetration Testing & Ethical Hacking

Instructor: Greg Bailey . . . . . Brookside (1ST LEVEL)  
*Extended Hours: 5:00pm – 7:15pm (Course day 1)*

### SEC566 Implementing and Auditing the Critical Security Controls – In-Depth

Instructor: Brian Ventura . . . . . Westport (3RD LEVEL)

## BONUS SESSIONS

#### SPECIAL EVENT:

### General Session – Welcome to SANS

Speaker: Kevin Ripa  
Mon, June 10 | 8:00am – 8:30am  
Southmoreland (1ST LEVEL)

#### KEYNOTE:

### Digital Forensics in Today's Storage World

Speaker: Kevin Ripa  
Mon, June 10 | 7:15pm – 9:15pm  
Southmoreland (1ST LEVEL)

#### VENDOR EVENT:

### Lunch & Learn

Tue, June 11 | 12:30pm – 1:15pm  
Southmoreland (1ST LEVEL)

#### SANS@NIGHT:

### Are You Certifiable?

Speaker: Ron Hamann  
Tue, June 11 | 7:15pm – 8:15pm  
Southmoreland (1ST LEVEL)

#### SANS@NIGHT:

### Raising the Bar for the Attacker [or: You Can Have My Network When You Pry It From My Cold, Stiff Hands]

Speaker: Greg Scheidel  
Wed, June 12 | 7:15pm – 8:15pm | Southmoreland (1ST LEVEL)

#### SANS@NIGHT:

### Am I the Purple Fox or the Purple Hound: Understanding the New Tools of the Red Team Trade

Speaker: Greg Bailey  
Thu, June 13 | 7:15pm – 8:15pm | Southmoreland (1ST LEVEL)

## Interested in adding a GIAC Certification or an OnDemand Bundle?

To receive the discounted rate, you must sign up before Friday, June 21st at 8:00pm EDT

Add to your order via your Portal Account: [www.sans.org/account](http://www.sans.org/account)

Call or e-mail SANS Registration: **1-301-654-SANS (7267) | [registration@sans.org](mailto:registration@sans.org)**

# HOTEL FLOOR PLAN

## 1ST LEVEL

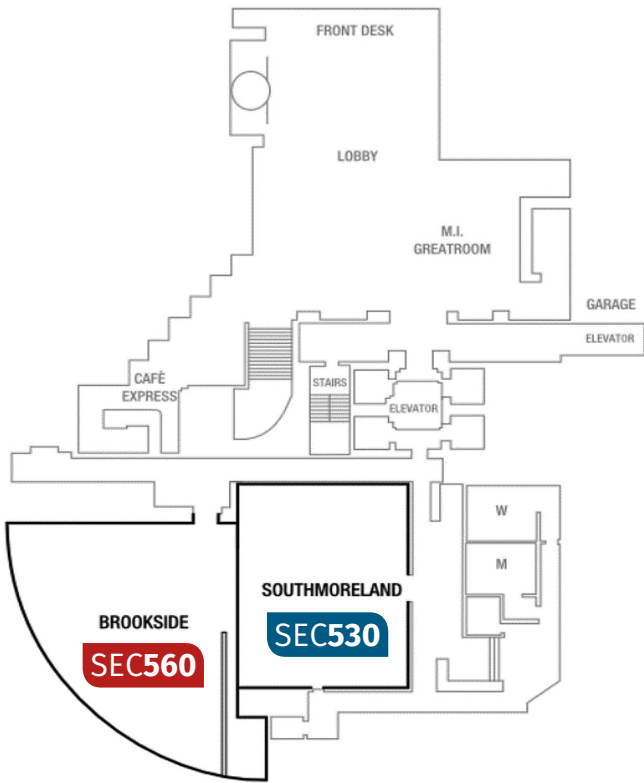

## 2ND LEVEL

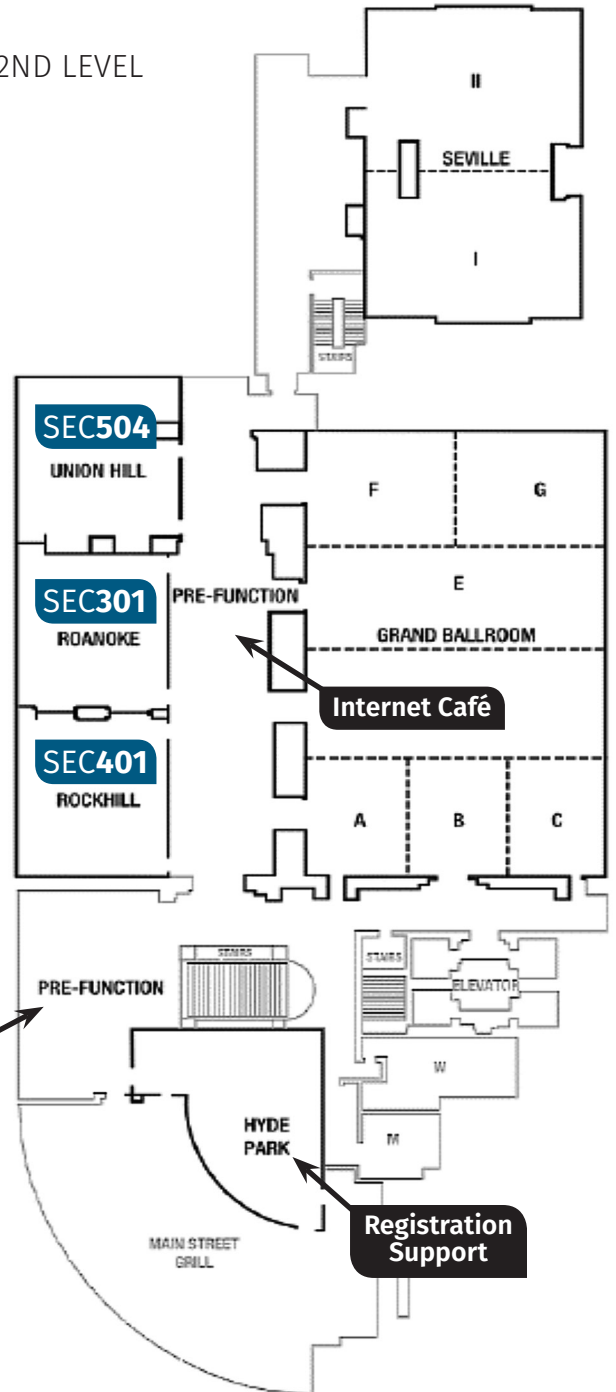

## 3RD LEVEL

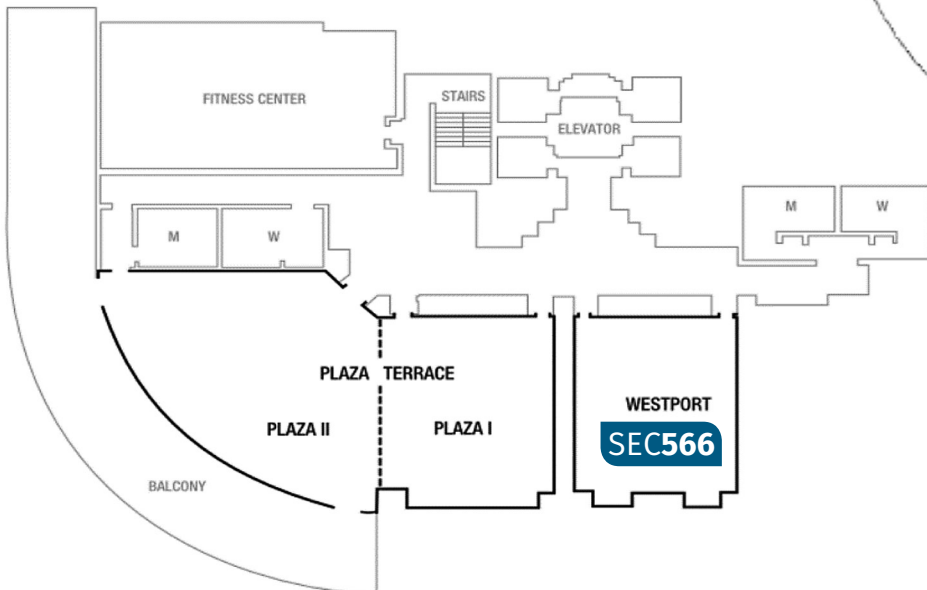

Event Check-In

Internet Café

Registration Support